

THE **Kith**

CONDOMINIUMS

Daniels
love where you live™



Illustration is artist's concept. E. & O. E.



we are all one.

we are all kith.



what is kith?

Kith & Kin – a beautiful expression initially coined in the 14th century that speaks to the closeness of one's country and relatives. Today the phrase takes on a new meaning to include the expanded essence of those we hold close to our hearts. A new definition of family – one that includes our friends, neighbours, and people in our community.

KITH is coming together to create something special.

KITH is caring for each other like family.

KITH is celebrating milestones with new friends.

KITH is sharing and learning from one another.

KITH is living in harmony every day.

15
storeys

316
suites

**Studio - 2
bedroom
suites**



Welcome to The Kith Condominiums. An aspirational concept in community living where every individual contributes equally to being an integral part of the community as a whole. A beautiful vision that connects people of all ages and stages of life with passion and purpose. Belonging to The Kith is an instant feeling of warmth and acceptance from the moment you arrive. It's a community that cares about the quality of *how* you live just as much as *where* you live.

Located at Erin Mills Parkway and Eglinton Avenue West, The Kith is **your final opportunity to own a home** in a modern condominium in the beautiful master-planned, multi-generational Daniels Erin Mills community. Thoughtfully designed to create meaningful connections between people and spaces, residents will appreciate indoor and outdoor lifestyle amenities to socialize, play and celebrate an active way of life.

As an energetic and evolving community, Erin Mills offers one of the finest and convenient lifestyles in the GTA. Its central location within Mississauga connects residents to vibrant and nearby amenities, all while living in a welcoming neighbourhood close to natural green spaces. To deliver even more convenience to the day, residents can enjoy a selection of retail at the base of the condominium.

our roots
are grounded
in Erin Mills.



In the late 1970's, The Daniels Corporation's late Founder and Chairman, Mr. John H. Daniels, was a moving force behind the 'new town' of Erin Mills. His vision for what was to come in the City of Mississauga was, and still is, extraordinary. Today, we are proud to continue to bring that vision to life.



Visionary and vibrant, the first chapter of the Daniels Erin Mills community was designed to ensure that people truly love where they live. More than just residential buildings, this exceptional lifestyle community includes retail, offices, and unique outdoor amenities that all residents can enjoy.

Daniels is thrilled to introduce the final chapter, as we expand this community with an exciting mix of condominium suites and a premium seniors residence at the north east corner of Eglinton Avenue West and Erin Mills Parkway. Following the incredible success of Kindred Condominiums, The Kith marks your final opportunity to own a home in this visionary community.

- Daniels Erin Mills West Tower**
- Skyrise Rental Residence**
- Arc Condominiums**

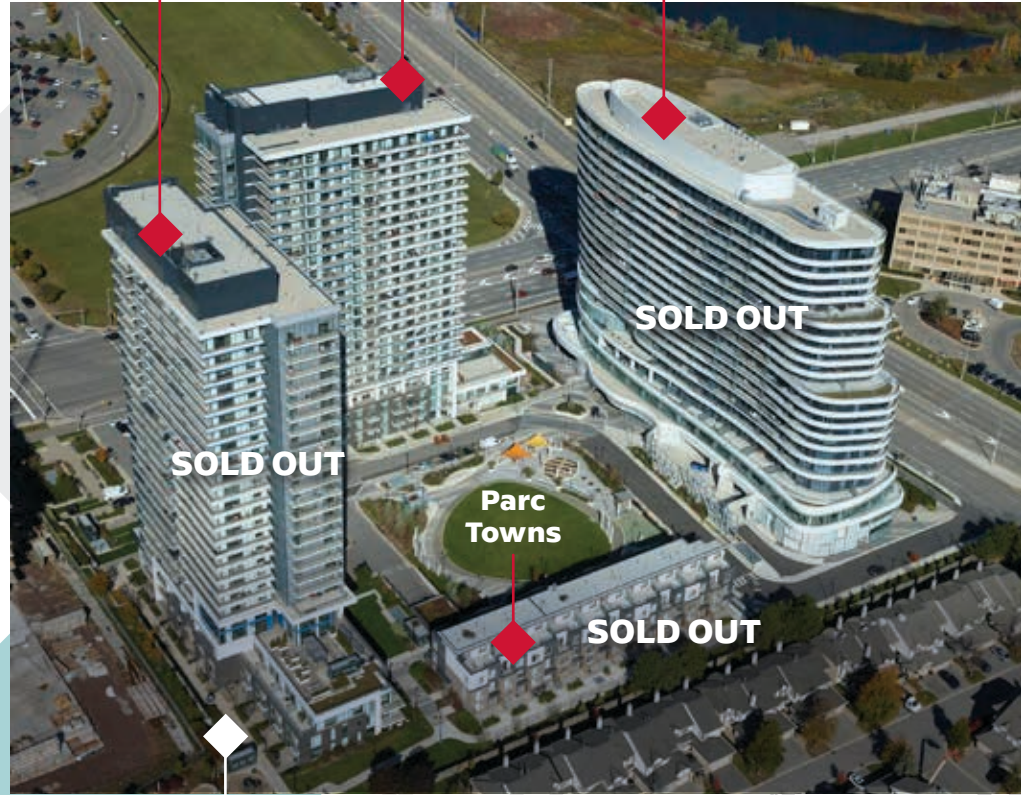

THE Kith
CONDOMINIUMS

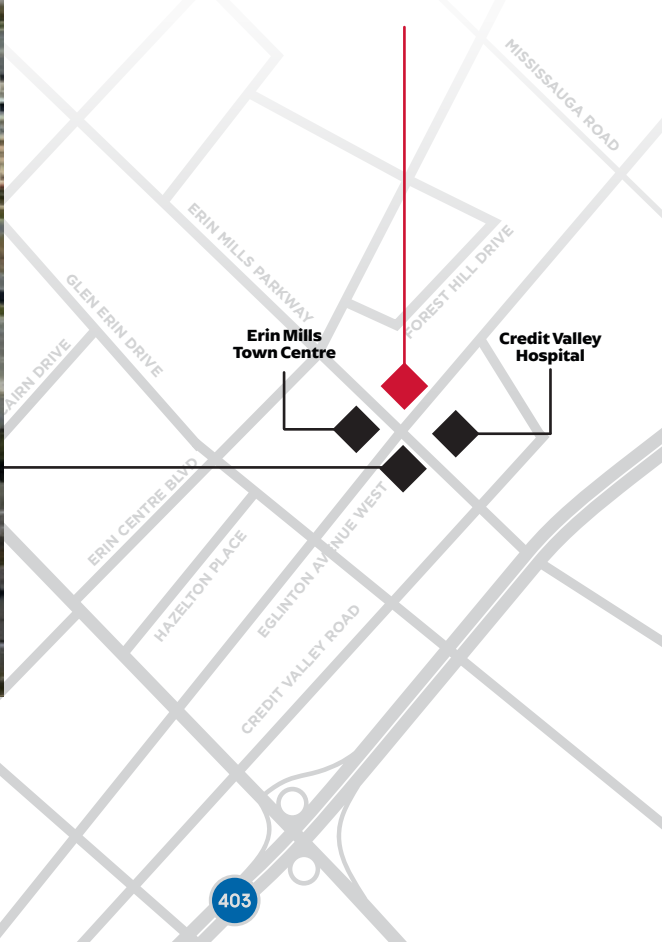

Daniels Erin Mills
South West Corner of
Eglinton Ave. W. and
Erin Mills Pkwy

Map is not to scale. E. & O. E.

THE Kith

CONDOMINIUMS

KINDRED

CONDOMINIUMS

INCREDIBLE SUCCESS

Daniels Erin Mills
Community,
South West Corner

SOLD OUT

FINAL OPPORTUNITY

Credit Valley
Hospital

Erin Mills
Town Centre

EGLINTON
AVE W

Premium Seniors'
Residence in
Partnership with
Amica Senior
Lifestyles
Coming Soon



Daniels

love where you live™

over 39 years & building strong

THE DANIELS CORPORATION BUILDS WITH A PASSION FOR CREATING VIBRANT COMMUNITIES IN EVERY SENSE OF THE WORD. DANIELS LOOKS BEYOND THE BRICKS AND MORTAR, INCLUDING SOCIAL, CULTURAL AND ECONOMIC INFRASTRUCTURES THAT WILL CREATE A UNIQUE SENSE OF PLACE. THIS COMMITMENT HAS BEEN AN INTEGRAL PART OF DANIELS' CORPORATE PHILOSOPHY FOR OVER 39 YEARS.

Daniels has built over 39,000 award-winning homes and apartments, master-planned mixed-use, mixed-income and multi-generational communities as well as commercial and retail spaces, and has earned its standing as one of Canada's largest and preeminent builders/developers. The late company Founder and Chairman, John H. Daniels was a towering figure in the North American real estate industry. In a career that spanned over 60 years, the former CEO of Cadillac Fairview Development Corporation has left an indelible mark on the quality of the places in which people live, work, play, create, learn, and shop.

Led by company President and CEO Mitchell Cohen and a creative team of visionary professionals, The Daniels Corporation's integration of residential and commercial divisions results in a stable turnkey operation, which earns the company a high level of industry and public trust. Daniels plans, designs, develops, builds, and manages all residential and commercial properties in-house, enabling the ultimate in quality control and streamlined service. In essence, Daniels is an all-inclusive service provider – a company dedicated to seeing each project through to construction completion and beyond.



CF TORONTO EATON CENTRE
DOWNTOWN TORONTO



DANIELS CITY CENTRE
MISSISSAUGA

Innovation in master-planning

Daniels transforms underutilized land into sought-after master-planned communities that include residential, name-brand retail and commercial opportunities. Daniels' land-use planning is based on the principle of integration into the existing urban fabric, creating neighbourhoods that fit seamlessly into their surroundings, providing a broad customer base of homebuyers, retailers, and commercial businesses. For example, Daniels is partnering with Toronto Community Housing to revitalize 53 of the 69-acre Regent Park community in Toronto's Downtown East, which is being looked at around the world as the gold standard by which challenged urban neighbourhoods can be re-imagined as healthy, sustainable communities.

Today, Regent Park is the global hub of urban Sustainability Development Goals and home to the World Urban Pavilion – Powered by Daniels, a collaborative initiative between the Urban Economy Forum, UN-Habitat and supported by Canada Mortgage and Housing Corporation and The Daniels Corporation. The Pavilion is a knowledge

exchange hub to share best practices, innovation and research in urban development and revitalization from countries around the world.

Daniels also partnered with renowned filmmaker Ivan Reitman to build TIFF Bell Lightbox, an international destination for the world of film. In addition to the iconic home of the Toronto International Film Festival, this mixed-use development includes restaurants, ground floor retail, a commercial parking garage and the 44-storey Festival Tower Residence. Daniels has also created iconic neighbourhoods throughout the GTA, providing residential, retail, and commercial services within their NY Towers and High Park Condominium communities in Toronto, as well as Daniels City Centre and Daniels Erin Mills communities in Mississauga.



DANIELS ERIN MILLS
MISSISSAUGA



DANIELS OMG 2
BRAMPTON

Sustainability

Long before “green” became an industry buzzword, The Daniels Corporation has taken a proactive approach to protect the environment through innovation in design and construction. For many years, Daniels has led the urban food revolution within the Canadian building industry through trailblazing urban agriculture initiatives that incorporate farmers’ markets and urban allotment gardens into its residential communities.

Guided by the principles of transparency, accountability, and collaboration, Daniels’ mission towards sustainability is to lead the transformation of an entire industry by committing to significantly decarbonize our new communities. Daniels continues to build for environmental sustainability by going beyond industry standards and publishing the Daniels’ Decarbonization Roadmap, a company-wide response to the climate emergency with a plan to reduce carbon emissions in current and future projects. The Roadmap outlines the limits on carbon impacts for new communities and

a series of technological and process-based strategies to assist in meeting carbon reduction commitments. In Toronto’s Regent Park, Daniels completed its first EcoUrban Designed community, Field House EcoUrban Towns. This community stands as a trailblazing collection of townhomes offering homeowners the opportunity to live fossil fuel free with features like solar rooftop panels, high-efficiency heat pumps and triple-glazed windows. Daniels is currently constructing their next EcoUrban community, Daniels MPV2 in Brampton’s Mount Pleasant Village. As Brampton’s largest low-carbon master-planned community, it will feature mid-rise towers that utilize geoexchange, a low-carbon heating and cooling system that uses the Earth as a thermal battery, and Net-Zero townhomes with rooftop solar panels. As some of the first projects designed with Daniels’ Decarbonization Roadmap commitments, these ground-breaking communities will ensure long-lasting positive impacts on the environment for years to come.



DANIELS WATERFRONT - CITY OF THE ARTS, IN PARTNERSHIP WITH WJ PROPERTIES
TORONTO



DANIELS MPV2
BRAMPTON



DANIELS SPECTRUM
REGENT PARK

Illustrations are artist's concept. E. & O. E.

Building for everyone

Dedicated to upholding a “people-first” philosophy, Daniels has long been a champion of affordable rental and ownership housing and has built 3,600 affordable rental-housing units under several government programs. Daniels was the first developer to offer purpose-built rental housing in the Greater Toronto Area in 25 years through its Gateway Rental portfolio. In partnership with Sun Life, Daniels has built market rental residences as part of its Daniels Erin Mills community in Mississauga and in Toronto’s Regent Park.

Daniels FirstHome™ communities across the GTA provide quality-built residences priced within the reach of first-time buyers paired with a one-of-a-kind experience and incentives to help make the dream of homeownership a reality. In selected communities, Daniels is also partnering with Amica Seniors Lifestyles, Chartwell Retirement Residences and WellTower to deliver a continuum of housing options for older adults across the GTA. Daniels is also the builder partner for the new Spadina-

Sussex student residence at the University of Toronto, which will include amenity and retail space for the university’s downtown campus. On the commercial end of the spectrum, Daniels creates outstanding business opportunities for national brand companies as well as grassroots not-for-profit organizations.

Daniels has established an outstanding reputation for making bold commitments in innovation and inclusivity in their communities. Recognizing that physical challenges exist for many people in their surroundings, Daniels created the Accessibility Designed Program to break down those barriers. This important program incorporates thoughtful design details into suites that go beyond the standards of the Ontario Building Code (OBC) and are available at no additional cost. Over the past 39 years, Daniels has embraced financial and hands-on generosity toward a number of charities and non-profit organizations, including Second Harvest, Habitat for Humanity and Covenant House Toronto.



2023 HOME BUILDER OF THE YEAR MID/HIGH-RISE (BILD)



2023 DIVERSITY, EQUITY & INCLUSION AWARD (BILD)



SIX-TIME WINNER OF THE TARION HIGH-RISE BUILDER OF THE YEAR AWARD

HOME BUILDER OF THE YEAR AWARD

COMMUNITY OF THE YEAR AWARD (BILD)

GREEN DESIGN AWARD

COMMUNITY OF THE YEAR – URBAN AWARD

TARION'S 2019 ERNEST ASSALY AWARD RECIPIENT



love
where
you liveTM

a promise you can count on.

Our promise that you will “Love Where You Live” is weaved into every aspect of our communities, starting with careful thought and consideration at every stage of the design and development of each community we build. When you purchase with Daniels, you can expect your new home to be built with the highest level of attention to detail. You can also feel confident in our all-inclusive approach that ensures excellence in construction quality and superior customer service from the day you purchase, to move in and beyond.



social impact

our homeowners help power our purpose.

Each new resident of a Daniels home helps power our purpose to use real estate as a tool for positive impact.

At Daniels, our purpose is to build inclusive and sustainable communities to create a better future for all. To realize this purpose, we embed impact into everything we do. We cultivate powerful partnerships, building community capacity and supporting food and urban agriculture initiatives. We also invest in the local economy through social procurement, and create opportunities for affordable housing. Building inclusive, resilient communities where everyone belongs, feels welcome and at home is about more

than bricks and mortar; it is about integrating building excellence with opportunities for social, cultural and economic well-being.

We are committed to leading by example, listening to and learning from the communities in which we build. Every resident in our communities is central to our ability to create positive impact through our work, and we are grateful to each and every one of them for supporting our unique approach to development.

SOCIAL PROCUREMENT

Social procurement is a powerful tool to generate economic impact.

We recognize our opportunity to leverage our business as a tool for inclusive local economic growth. That's why we purchase with intentionality and with a lens sharply focused on making a positive impact on local economies. From catering to security and groundskeeping services, to artwork and welcome gifts, we look for ways to allocate funds to support businesses in every community we build. In fact, all artwork procured for display in the common area amenities of Daniels communities is sourced from local emerging and mid-career artists. We also work with social enterprises such as Artscape Atelier to procure welcome gifts for new homeowners created by artists with roots in each of our new home communities.



Daniels has commissioned a number of quilts from Sakina's Sewing Circle, a collective of Bangladeshi women who gather together to sew and socialize.

**OVER
\$625K
PROCURED**

In 2021-2022, over \$625,000 in local artwork and artisan-created welcome gifts was socially procured by Daniels. Over 97% of these local artists and artisans belonged to equity-deserving groups.

Building Community Capacity

Our “love where you live” promise extends beyond each Daniels home to our communities across the Greater Toronto Area.

For Daniels, our work building communities doesn't end when construction does. Throughout our history, we have developed partnerships with not-for-profit organizations, collaborated with grassroots groups and supported community initiatives demonstrating that our approach to city-building puts people at the centre.

In 2020, we announced a new location partnership with Studio.89, a non-profit community hub serving fair-trade coffee to fund community programs related to sustainability, conscious consumerism, community dialogue and youth leadership. Located within our Daniels Erin Mills Presentation Centre at Arc Condominiums, Studio.89 seeks to empower community to act locally and think globally for a sustainable future. With Daniels' support over the last three years, Studio.89 has become a neighbourhood favourite; hosting programs and events accessible to the broader Erin Mills community.



**OVER
\$850K**

**CONTRIBUTED IN
SPONSORSHIPS AND
DONATIONS**

In 2021-2022, Daniels contributed over \$850,000 in sponsorships and donations, supporting over 35 different not-for-profit organizations and initiatives across the GTA.

social impact

AFFORDABLE HOUSING

Partnership is key to the affordable housing solution.

There are many financial barriers that can separate individuals and families from a safe and affordable place to call home. At Daniels, we've created pathways to affordable homeownership for hundreds of families through partnerships, innovation and financial assistance programs.

Daniels is proud to have built more affordable homes than any other private sector company in Canada. For over 25 years, Daniels has partnered with Habitat for Humanity GTA and local affiliates to empower families in need of a safe and affordable place to call home.

In 2008, Daniels donated land to Habitat for Humanity for the construction of 10 townhomes in Lakeshore Village in Etobicoke — the single largest donation of land by a private company in Habitat Canada's history. To date, Daniels has contributed over \$6 million to Habitat for Humanity, which has resulted in safe, affordable and healthy homes for over 90 Habitat partner families across the GTA.

OVER \$6M CONTRIBUTED | **OVER 90** HABITAT PARTNER HOMES DELIVERED & UNDER CONSTRUCTION



HABITAT GTA PARTNER FAMILY

FOOD AND URBAN AGRICULTURE

Food and urban agriculture grow healthy, vibrant communities.

We recognize the role that a sense of community and connection plays when it comes to overall health and well-being. That's why we create shared spaces and experiences that bring people together. We built our first rooftop garden in 2009, and now incorporate opportunities for urban agriculture across our portfolio of communities. In fact, between 2021-2022, we built 284 new urban agriculture plots and engaged 400 new residents in garden programming.



Daniels invests in creating physical space for gardens, as well as facilitating programming for residents to come together and help community connections flourish!

BETWEEN
2021-2022,
WE BUILT
284

new urban agriculture plots across our new communities for community gardening!

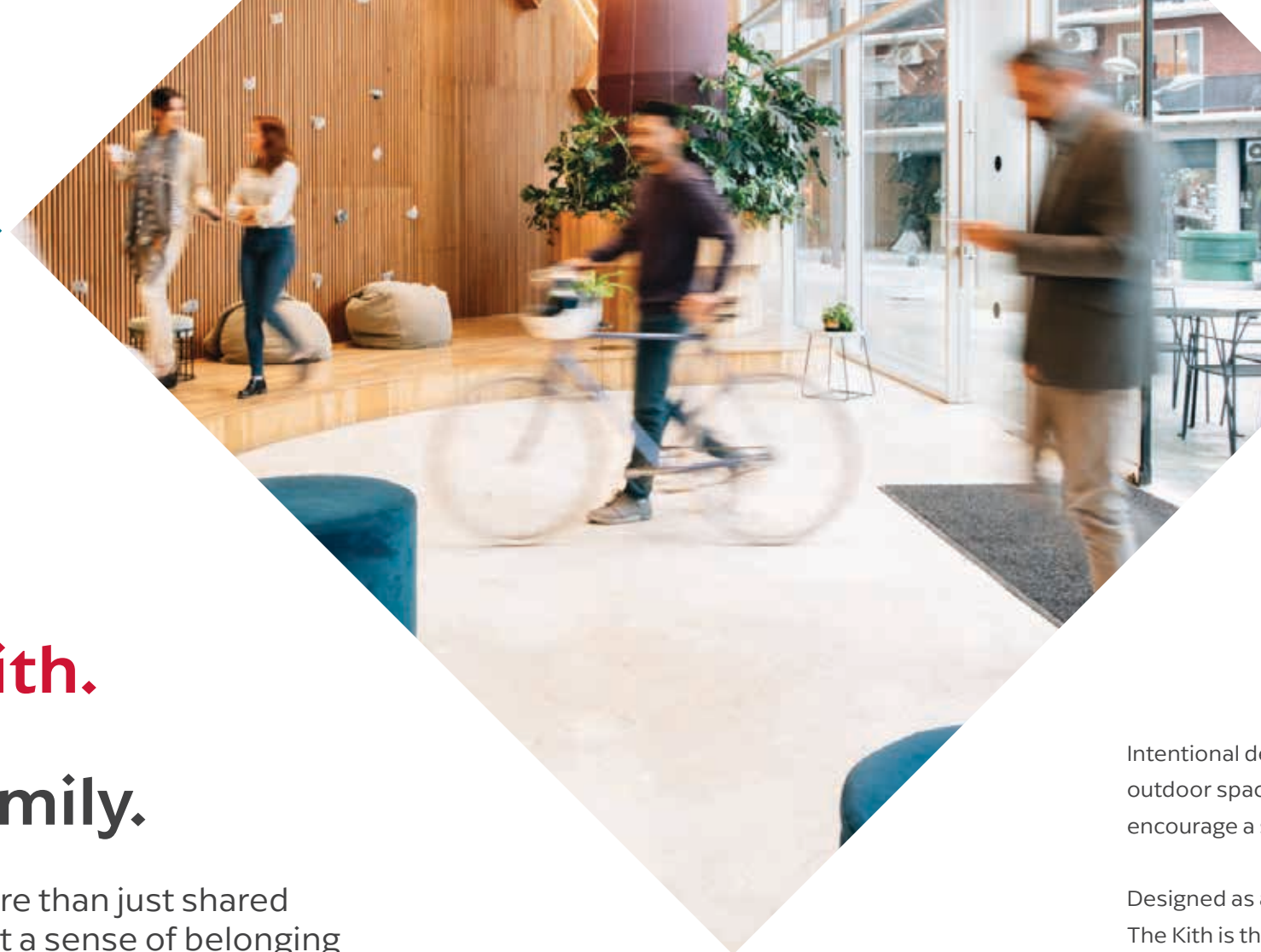

we are all kith. a part of an inclusive family.

Community is about more than just shared physical space. It's about a sense of belonging and connection that brings people together.

A strong and vibrant community is one that welcomes all and fosters a culture of inclusivity, independence, and mutual support. The concept of community was at the forefront of everything considered for the Daniels Erin Mills master-planned, multi-generational community.

Intentional design created a place where common indoor and outdoor spaces facilitate connectivity between residents to encourage a sense of community and social interaction.

Designed as a collective of three unique residential opportunities, The Kith is the final cornerstone coming to this community. It joins the modern 25-storey Kindred Condominium and a new premium seniors' residence. Daniels Erin Mills is a proud example of community living where everyone has a shared sense of place and home.

we are all kith. working
towards a shared vision.



ARCHITECT & INTERIOR DESIGN

Started in 1981 as Kirshenblatt Korman Architects, Kirkor Architects and Planners has grown into a studio of 150 architectural and design professionals in Toronto and Calgary. From our roots in community-based housing and in the early days of condominium development in Toronto, Kirkor is recognized as one of Canada's pre-eminent development architecture firms with world-class expertise in large-site development and master-planning, development and planning negotiations, tall-building and mid-rise architecture, all with a dedicated focus on complex mixed-used, residential primary building programs.



LANDSCAPE ARCHITECT

Founded in 1987, NAK is widely recognized as one of North America's leading landscape architecture and urban design practices. With work spanning the public and private sectors, significant public spaces, community master plans and unique private commissions, NAK has an established reputation for design creativity that is elevated by an executional approach unmatched in its rigour.

NAK believes in an approach to landscape architecture and urban design that contributes to the health and viability of the communities we live and work in. Our practice is acknowledged for creating economic and social impact and unlocking the full potential of designed environments.





site plan. ♦



we are all kith. **celebrating our** **moments as one.**

Say hello to your neighbour, share a story, a recipe, or a cup of chai, and suddenly you've made a new friend.

At the heart of The Kith Condominiums lies a commitment to creating community engagement and shared experiences that will encourage new connections. Connections with work, play, well-being, and most importantly, good times. There will also be a special connection to nature, with interiors designed to invite the great outdoors inside. Inspired by the latest trend in biophilic design, this practice blends natural materials, daylight and the inclusion of green space indoors, connecting people and nature within the building environments. With over 12,000 square feet of indoor and outdoor lifestyle amenities, the community offers a wide range of opportunities to bring everyone together.



entrance

welcome home

Arrive home to a community that invites you in with modern architecture and a welcoming entryway.

Illustration is artist's concept. E. & O. E.



outdoor oasis



an outdoor oasis

Experience an exclusive enclave of nature within this master-planned community that offers the perfect place to come together just steps from your front door. Get your green thumb on with your neighbours at the community gardening plots, workout at the outdoor calisthenic area or relax fireside with family while the kids enjoy their adventures on the playground. Landscaped walkways lead to the community piazza, a gathering spot for residents in the master-planned community. This space will foster new connections and features seating areas to meet neighbours, a nature play for the children and places to enjoy the outdoors.

Illustration is artist's concept. E. & O. E.

ground level

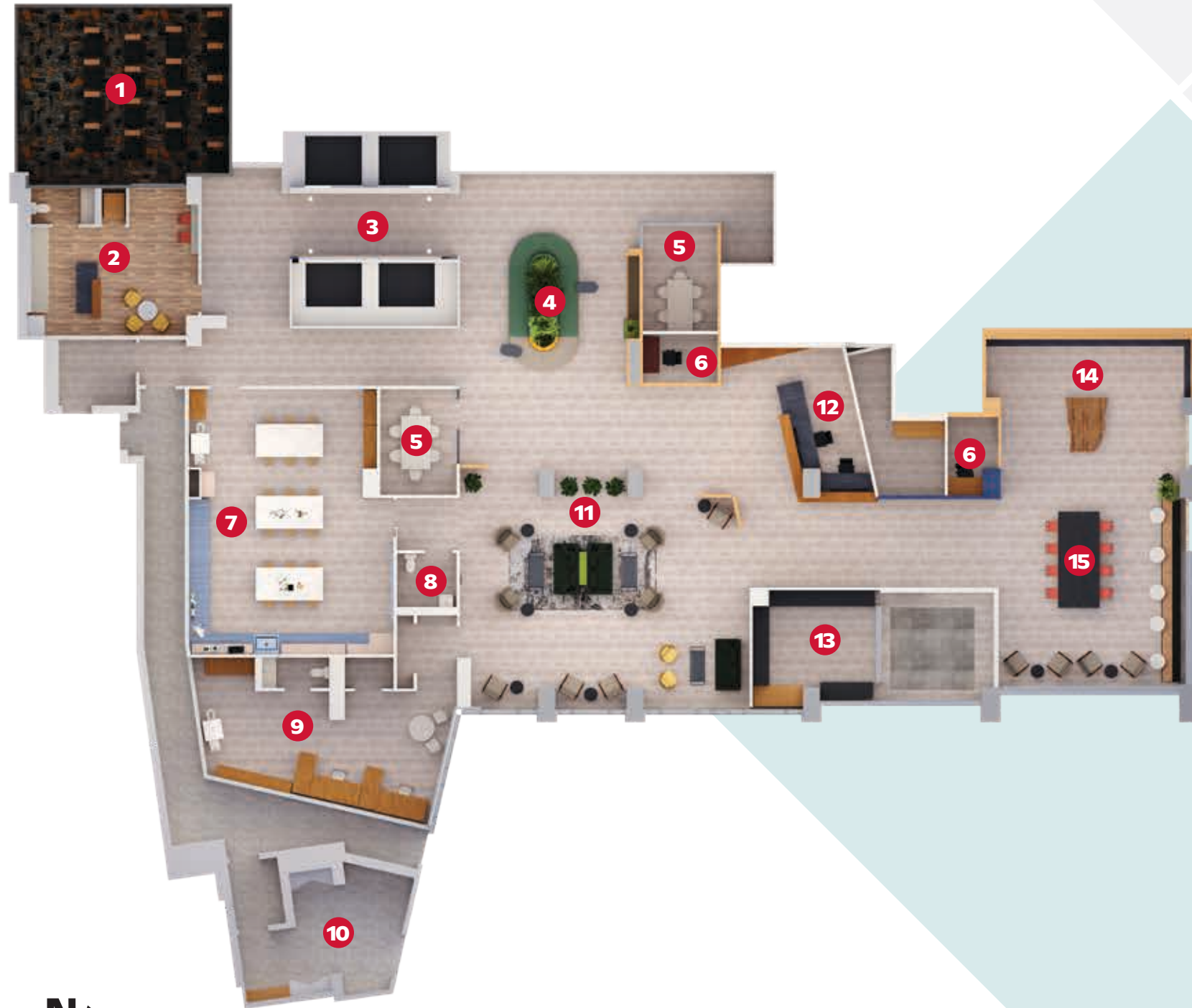

The ground level features convenient amenities for you and your family to enjoy.

- | | |
|-------------------------|-------------------------------|
| 1. Theatre | 9. Property Management Office |
| 2. Theatre Lounge | 10. Pet Wash |
| 3. Elevators | 11. Connection Lounge |
| 4. Lobby | 12. 24/7 Concierge |
| 5. Meeting Room | 13. Parcel Room |
| 6. Phone Booth | 14. Mail Room |
| 7. Circular Economy Hub | 15. Co-Working Space |
| 8. Universal Washroom | |





lobby

a haven to come home to.

Step into a modern lobby lounge adorned with natural, neutral tones and textures to create a warm and welcoming space to greet family and socialize with neighbours. Conveniently located off the lobby, you'll find a secure parcel storage room for packages, the mail room and a pet wash for your furry friends.

Illustration is artist's concept. E. & O. E.

harmony at work.

Collaboration is the key to success, as is the environment you work in. Filled with natural light, expect to be brilliant in the sleek and stylish Co-Working Space. Catch up on work, read a book or gather as a group and let the brainstorming begin. This inspiring workspace helps get the job done in a bright, functional fashion. If you are looking for a more intimate space, there are meeting rooms and phone booths available for additional privacy.



Illustration is artist's concept. E. & O. E.

co-working space



connection lounge

Illustration is artist's concept. E. & O. E.

stay connected.

The Connection Lounge is the perfect environment to meet new neighbours or stay connected with old friends. The cozy atmosphere provides ample seating to gather, socialize and make new memories.



everything is more fun together.

Cheer on your favourite sports team, host a movie night with friends or enjoy a jam session with your neighbours in the Theatre Room. Acoustically designed to encourage loud cheers or music practice, this room is ideal for both entertainment and relaxation. The Theatre Lounge features a servery and area for snack prep, so you can enjoy treats while you watch the big screen or listen to music.

theatre room



reuse, repair, relove!

Nothing says community like coming together to share and support each other. The Circular Economy Hub is a place dedicated to creating, learning, and sharing skills. A welcoming environment for everyone, the room has spacious workstations and tools for your “DIY” or art projects. It’s also a space for upcycling, exchanging, or donating goods to others. Swap and share skills, fix furniture and computers, sew a shirt, and make new friends while doing it.



Illustration is artist's concept. E. & O. E.

Level 4

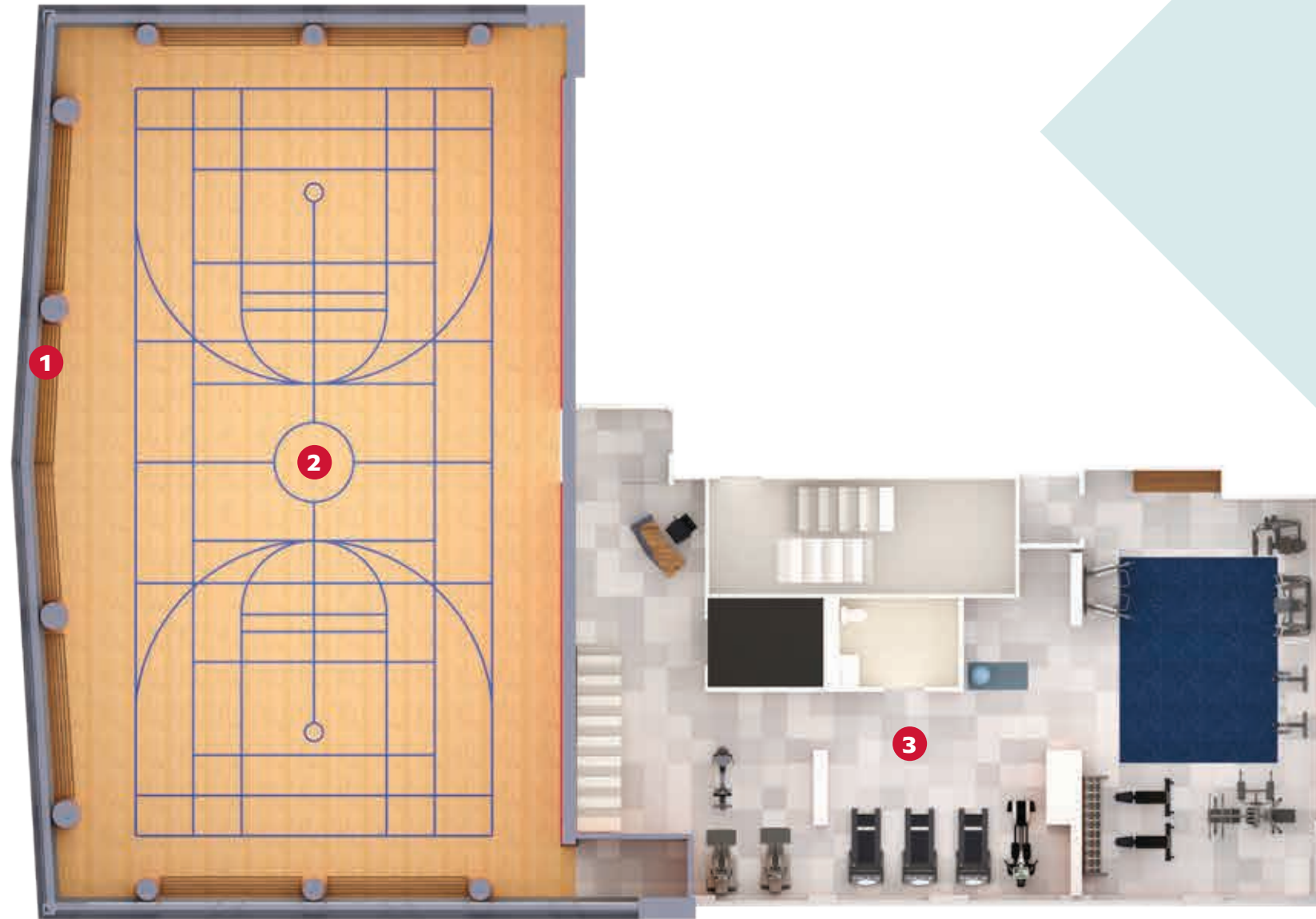

The 4th level amenities provides ample space to live a healthy and fit lifestyle.

1. Indoor Track
2. Gymnasium
3. Fitness Centre



bffs – best fitness friends.

Stay motivated, reach your fitness goals and feel your best in a space designed to promote well-being and fun times. Team up with your friends and enjoy a game of basketball in the Gymnasium. Jog around the Indoor Track above the court for a quick warm up then let the games begin!



Break a sweat in the Fitness Centre, equipped with a selection of free weights, cardio machines and strength training equipment.

Level 7



The 7th level amenities provide a seamless flow between the great outdoors and beautiful indoor spaces to entertain, socialize and relax.

1. Outdoor Terrace
2. Party Room
3. Dining Room





party room

Illustration is artist's concept. E. & O. E.

good company. good times.

Get together with friends or make new ones in a socially infused space that will guarantee a good time. Featuring a kitchenette, comfortable seating and a big screen TV, the Party Room is the perfect space to host a private event.

a feast with family.

Expand the celebration and extend the invitation to all your family and friends in an elegant lounge space set up to host a memorable event. Connected to a private vestibule, this room is ideal for larger dinner parties and special celebrations. This space features a large dining table, bar with stool seating and handy servery making meal prep easy. Extend the party outside and cook up an al fresco BBQ feast to enjoy under the stars.



Illustration is artist's concept. E. & O. E.

dining room



outdoor terrace

a breath of fresh air.

Embrace the great outdoors on the terrace that provides the perfect place to lounge in the sun, relax with a good book or take in a sunset over an al fresco dinner. Enjoy a beautiful environment decorated with raised and individual planters, a custom trellis, and a large shade structure. There are spots for lounging and dining, including bistro-style seating and dedicated BBQ stations.

Illustration is artist's concept. E. & O. E.



This is your space.

Your time and place to be with family and friends; or to carve out some quality time on your own. A haven to honour traditions and create new ones. To make memories and celebrate milestones. It's your environment to get inspired in, decorate, and feel perfectly happy at home.



Warm, inviting and filled with new possibilities – this is your space. Every detail is thoughtfully designed to seamlessly blend urban style with natural elements and quality finishes, ensuring contemporary comfort. Enjoy a modern open concept living space you'll be proud to call home.

Illustrations are artist's concept. E. & O. E.



designing possibilities. removing barriers.



Daniels is committed to providing a higher standard in accessibility designed homes for people of all mobility levels. A selection of suites will be offered through Daniels' Accessibility Designed Program (ADP) that exceed the accessibility standards set by the Ontario Building Code. Recognizing mobility needs vary among individuals, standard accessible layouts are available at no additional cost. These standard layouts include accessible features such as power-operated entry door roughin, wider doors throughout, roll-in showers, and roll-out balconies, to name a few.



The Kith Condominiums is pursuing the Gold rating from the Rick Hansen Foundation Accessibility Certification™ (RHFAC) program. This program is designed to challenge developers like Daniels to go beyond the building code and create innovative solutions to make their communities universally accessible. Taking the approach of designing for accessibility and keeping inclusivity top of mind at every stage of the development process helps us to ensure that every resident can love where they live.



we are all kith. taking care of each other and the environment.

Taking care of ourselves and the Earth is of utmost importance inside, outside, and all around.

At Daniels, we have both an opportunity and a responsibility to take action to reduce our carbon footprint and leave a legacy for future generations. That's why Daniels is committed to designing and building low-carbon communities that minimize their impact on the environment.

The Kith Condominiums will be designed and built with sustainability in mind. As such, it is registered with the intention of earning LEED® certification upon its completion. The LEED® green building program is the preeminent program for the design, construction, maintenance, and operations of high-performance green buildings.



sustainability features.

The Kith Condominiums has been designed with sustainability features that benefit both you and the environment.



Energy Recovery Ventilator (ERV)

An energy-efficient fresh-air supply system that draws clean, outdoor air into your home, while exchanging heat and humidity with the stale exhaust air to ensure comfortable indoor conditions are maintained.



Sub-Metering of Electricity and Water

Individual utility metering promotes conscientious consumption and reduces long-term maintenance fees.



ENERGY STAR® Appliances

ENERGY STAR® is a certification program managed by Natural Resources Canada. ENERGY STAR® certified products are tested and certified to meet strict specifications for energy performance.

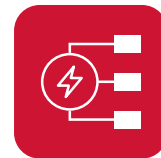

EV Charging

The parking garage has been designed with the future of EV charging in mind – to facilitate future expansion of EV charging throughout. Upgrade to the seamless EV Turnkey package to have access to safe, secure, and convenient EV charging right when you move in.



Water Efficient Plumbing Fixtures

Reduces water consumption while maintaining pressure and lowering utility bills.



Waste Sorting: Bi-Sorter

A convenient and efficient waste and recycling system that directs resident materials into recycling or waste containers using a single chute with a sorting mechanism.



Circular Economy Hub

An amenity space dedicated to reusing, repairing, upcycling, exchanging, or donating goods in order to divert them from landfills.



Urban Agriculture

Community garden plots available to residents to grow food, while promoting a healthier lifestyle and reducing emissions from food transportation.



Rainwater-harvesting

Collection and storage of rainwater for reuse in irrigation systems to assist with the maintenance of landscaped features.



Drip Irrigation for Landscaping Features

A slow drip water irrigation system used to grow landscaping that saves water and reduces maintenance fees.



carbon label.

Daniels is on a mission to decarbonize the real estate industry in the Greater Toronto Area by focusing on the Whole Life Carbon impact of the homes we design and build. Our plan is detailed in our Decarbonization Roadmap, which positions Daniels as a leader in innovative and sustainable construction practices.

Daniels is publishing a carbon label that further breaks down Whole Life Carbon to quantify the emissions reduction from the innovative features and technologies implemented in new development projects. This label was developed as a means for voluntary disclosure of carbon performance to enhance our continuing efforts to decarbonize the homes we build. The carbon label shows the total carbon footprint for each square metre of floor area, combining both upfront and operating carbon emissions.

WHOLE LIFE CARBON

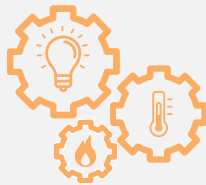

OPERATING CARBON

Emissions associated with the operation of a building including heating, cooling, lighting and more.



UPFRONT CARBON

Emissions associated with materials and construction processes including extraction of raw materials, processing, transport and on-site activities.



THE Kith

CONDOMINIUMS

DANIELS' EMISSIONS BASELINE

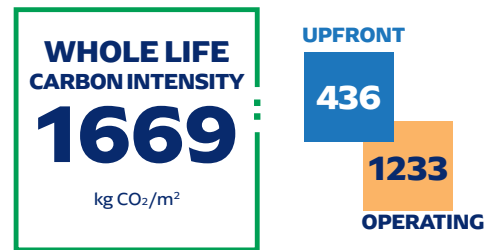

CARBON IMPACT BREAKDOWN

kg CO₂/m²

	EMISSIONS	%
UPFRONT	436	26%
■ Concrete	247	57%
■ Rebar	108	25%
■ Enclosure	58	13%
■ Other	24	5%
OPERATING	1233	74%
■ Heating	600	49%
■ Cooling	34	3%
■ Hot Water	278	22%
■ Other	321	26%

WHOLE LIFE CARBON INTENSITY

The Kith Condominiums was one of Daniels' pioneering communities to be studied for Whole Life Carbon Intensity and is included in our Emissions Baseline. By quantifying and reporting the carbon impact of our new communities, we aim to see continuous improvement over time to reach the goals outlined in our Daniels' Decarbonization Roadmap.

UPFRONT CARBON

A Whole Building Lifecycle Assessment was performed to study the key drivers of upfront carbon. Concrete and rebar were found to be the largest contributors, making up over 80% of the upfront emissions. This information is key to continuously improving our construction practices to find low-carbon alternatives in the future.

OPERATING CARBON

At The Kith Condominiums, energy-saving measures are already in place to improve thermal comfort, reduce fossil-fuel consumption and lower energy costs, such as efficient in-suite mechanical systems with energy recovery ventilation and low-flow plumbing fixtures.

Carbon emissions intensities are projections based on energy and lifecycle assessment modeling of Daniels communities during design; methodologies can be found in our Decarbonization Roadmap.



we are all kith. **a beautiful mix of culture, curbsides, and corners.**

Different is good, unique is exceptional, and sharing and celebrating in a diverse culture and community where the possibilities are limitless is a beautiful experience. **Erin Mills is this place.**

Here you will discover a vibrant mosaic of lush nature and beautiful parks woven into a thriving urban centre alive with thoughtful amenities and everyday conveniences that welcomes its residents with open arms. But what truly sets Erin Mills apart is its culturally rich and family-friendly community. With great schools, recreational facilities, and a strong sense of place and purpose, Erin Mills is a place where neighbours become friends and friends become family.

This unique lifestyle is a testament to the thoughtful planning and aspirational values at the core of Erin Mills. It presents a true community that encourages the charm of smalltown living with big-city perks. It is committed to preserving natural green space to inspire healthy living. And most importantly, fostering a sense of togetherness and inclusion.

As an energetic and evolving community, Erin Mills provides a suburban lifestyle that's second to none. It's an ideal location that serves up an idyllic connection to nature, an inviting community connecting residents to diverse choices and lifestyle amenities. And above all, it's a place where the people who call Erin Mills home define the city's heart and soul.





connected near and far.

There's a wonderful quality of life when you feel effortlessly connected.

Want beautiful nature? Want diverse urban amenities?
Want the best of both worlds? **You've got it here!**

Erin Mills offers abundant green spaces, parks to explore, and a thriving urban center just a short bus ride away in Mississauga's City Centre. When it comes to education, Erin Mills is a wise choice. The community boasts several top-rated public schools and the beautiful campus of University of Toronto Mississauga. The city also has you covered when it comes to healthcare, with Trillium Health Partners and the highly regarded Credit Valley Hospital located nearby.

an easy commuter connection.

Living in Erin Mills makes getting where you want to go a breeze! The local MiWay transit service offers a dedicated bus corridor with 12 stations running from east to west across the city. Catch a ride at Erin Mills Station, and you'll be on your way in no time. Erin Mills is also well-connected to the surrounding areas, with easy access to Oakville Transit, the Erin Mills GO Bus Station, and the Clarkson GO Train Station travelling east into Toronto or west into Oakville, Burlington, and Hamilton.

If you are commuting to Toronto for work or visiting for the day, the community is conveniently located near highway 403, providing quick access to highways 401, 410, 407, and 427 south to the QEW. For those who prefer a more scenic route, the closest GO Train Station is just 10 minutes away at the Erindale GO Station. From there, you can connect to Union Station in less than 40 minutes. With so many transportation options, getting where you need to go has never been easier.



where good nature exists inside and out.

In nature, diversity is wild and free. Every single element celebrates its own unique presence.

From the changing seasons and colourful leaves to the various birdsongs, vibrant summertime blooms and every individual snowflake – an innate harmony exists in the natural world. Get outdoors and find your place among the flora and fauna to connect with endless adventures and extraordinary beauty. With over 500 parks in and around Mississauga, choose your best play day from playgrounds, picturesque picnic spots and a wide range of sports fields, to scenic hikes, cross-country ski trails, toboggan hills and even a blissful day at the beach.

be one
with nature.



Tom Chater Memorial Park

Pick a field and let the games begin! This sizable park features three baseball diamonds, a soccer field, and lawn bowling/bocce ball greens. Add a playground, picnic facilities and a trail route through a friendly forest.



Lake Aquitaine Park

Imagine a man-made lake in your own backyard! This popular fishing spot boasts a natural habitat for rainbow trout, sunfish, largemouth bass, and perch. There are also extensive trails ideal for walking, cycling, inline skating and cross-country skiing during the winter.



Erindale Park

Discover something for everyone in a 222-hectare park that celebrates year-round outdoor activities. A famous spot for family picnics, there are five designated areas for groups ranging from 60 to 500 people, with barbecues and a water source. Kids will love the playground and toboggan hills, while hikers, joggers, cyclists, and cross-country skiers can explore a variety of trails such as the Culham Trail Loop and popular UTM Nature Trail through forests, ravines and along the river. A bird watcher's haven, a hot spot for fishing and beautiful background for wedding photos and nature lovers alike.



Jack Darling Memorial Park

Jack Darling Memorial Park

Located by Lake Ontario this scenic park features a long stretch of sandy beaches, natural waterfront areas and recreational parkland. With plenty of open space to play in, families can also enjoy two spacious picnic areas, playgrounds, a splash pad, and tennis courts. Explore both pedestrian and bike paths, follow a footpath to Rattray Marsh, a wetland reserve, along with waterfront trails and spots to launch windsurfers, canoes, or kayaks. There's also one of the largest fenced in dog parks too.



The Riverwood Conservancy

Made for nature lovers, this 150-hectare nature preserve on the Credit River invites the community to explore diverse trails to experience plants and flowers in themed gardens as well as learn about conservation.



O'Connor Park

Score the perfect place to picnic and play on almost seven hectares of parkland consisting of a natural wetland, spacious picnic areas, two soccer fields, modern playground and connecting walkway.



For social good & really good coffee

Visit Studio.89, a non-profit fair-trade café providing accessible programming that supports humans, animals, and the planet, plus serves the best coffee and ethical treats – right in the Daniels Erin Mills community. studio89.org

full of unique flavour, flair & fun.

Invite the world to your table.

Enjoy all the world's flavours right where you live in a diverse melting pot of authentic cuisine that celebrates every culture. From spicy Indian curries and savoury Mediterranean shawarmas to traditional Chinese dim sum and authentic Italian pizzas, you'll find it all here. Erin Mills also boasts a range of cafes, bistros and bakeries that cater to the occasion. Whether looking for a cozy brunch, an indulgent pastry, or a refreshing smoothie, you'll find something to satisfy your craving. So come hungry, come curious, and immerse yourself in the vibrant culinary scene Erin Mills offers.

Embark on a culinary adventure!

Shawarma Royale - Lebanese
Al Monasaba - Yemeni
Sahtain - Middle Eastern
Ritz Thali - Indian
The Kakori - Indian
South & Spicy - Indian
Silverspoon - Halal Pakistani/
South Asian
Mac's Sushi - Japanese
Sehmi - Japanese

Axia - Korean &
Southeast Asian kitchens
Hakka Spice - Indo-Chinese
Mandarin - Chinese
Rogues - Italian
J.P's Pizzeria - Italian
Brasas Churrasqueira
Rotisserie & Grill - Portuguese
Gladiator Burger & Steak - Canadian
Browns Socialhouse - Global

East Tea Can - Middle Eastern
Bait Sitty - Middle Eastern
Pump & Patio - Burgers Pub
Baldev Paan - Asian
Jimmy The Greek - Greek





on your mark, get set, SHOP!

Calling all fashionistas, retail therapists, mall maniacs and big box bingers!

If you are looking for something special or specific or simply enjoy shopping for exercise, get in some comfortable shoes and look no further than Erin Mills!

At the heart of it all lies the Erin Mills Town Centre - a shopping centre that offers an unbeatable selection of over 185 shops and restaurants. Anchored by household names like Walmart, Hudson's Bay, HomeSense, Indigo, and Old Navy, this shopping destination is a one-stop-shop for all your daily essentials. If that's not enough of a spree, the nearby South Common Centre is another must-visit spot for avid shoppers with 52 stores, eateries, and services to cater to your every need.

When ready to take your shopping game to the next level, head to Square One Shopping Centre - the epic all-day, shop-till-you-drop destination. Boasting a staggering 360 stores, including premier fashion brands like Zara, Michael Kors, and Harry Rosen, this retail paradise is sure to satisfy all your shopping desires. For even more choices, Heartland Town Centre is one of Canada's largest outdoor malls with over 180 stores, including big-box retailers such as Marshalls, Best Buy, Loblaws, and Canadian Tire.

For the ultimate top-tier fashion brands, the Toronto Premium Outlets in Halton Hills offers over 85 stores showcasing the latest fashions. And when you need to stock up on everything from groceries to home goods, a variety of big-box stores, including Costco and The Home Depot, are just a few minutes' drive away.





a culture of creativity.

Music, art, history, theatre, and people – take in the celebration of culture! Erin Mills is a community that truly embraces diversity and celebrates its unique cultural heritage.

It's on every street corner, every landscape, and in every person's smile. A beautiful tapestry of rich traditions and artful expressions that make this community an eclectic and constantly evolving hub for creativity.

Mississauga is so committed to enriching culture that the city has recently approved a Culture Master Plan that aims to create six uniquely themed cultural districts. The plan brings together the entrepreneurial spirit of business with the creative passion of the arts to introduce exciting new destinations offering entertainment venues, art galleries and green spaces for locals and visitors to celebrate culture.

This exciting initiative promises to enhance an already flourishing cultural scene, providing a space for people of all backgrounds and interests - from the classical to comedic, on stage, on the walls or in the square- to come together and celebrate their shared humanity through art and culture.

arts & culture for all.



Celebration Square

It's hip at the square! Everyone heads down for free concerts and events like movie nights, farmers' markets, vintage car shows and festivals. There's a big stage with jumbotrons, nice grass to lay on and a fountain with water jets that turns into a skating rink during winter months.



Bradley Museum

It's like stepping back in history. The kids love exploring the two-acre site, checking out the heritage buildings, barn, and log cabin. There are costumed tours and seasonal events like Maple Magic and Fall Fairs, plus accessible nature trails to the waterfront and Rattray Marsh where you can try and spot the great Blue Heron!



Living Arts Centre

Enjoy date night with something new to experience every month. This centre is huge with over 225,000 square feet of multiple performance venues. You'll love the symphony and choral shows, as well as a diverse selection of theatrical productions. There's also an evolving exhibition gallery along with seven art studios always offering up something new.

Art Gallery of Mississauga

Mississauga has so many art galleries and diverse shows, it'll be hard to choose a favourite. The Blackwood Gallery curates magnificent contemporary exhibitions and the Art Gallery of Mississauga showcases a rotating calendar of regional, national and international artists.



Meadowvale Theatre

From music, dance, comedy and local theatre, Meadowvale Theatre has it all. The level of talent is amazing, and the setting is intimate with just 395 seats so you really feel like a part of the show.



DANIELS ERIN MILLS

- 1 Kindred Condominiums
- 2 Daniels Parc Towns
- 3 Skyrise Rentals
- 4 Arc Condominiums
- 5 West Tower

FOOD & DINING

- 6 Al Monsaba
- 7 Axia Restaurant
- 8 Brasas Churrasqueira Rotisserie & Grill
- 9 Browns Socialhouse Erin Mills
- 10 Hakka Spice
- 11 J.P.'s Pizzeria
- 12 Karioka Fine Egyptian Cuisine & French Cafe
- 13 Mandarin Restaurant

- 14 Mona Fine Foods
- 15 The Kakori
- 16 Tim Hortons
- 17 Ritz Thali Mississauga
- 18 Rogues
- 19 Silverspoon Erin Mills
- 20 South N' Spicy

PARKS & TRAILS

- 21 Erin Centre Trail Park
- 22 Erindale Park
- 23 Erin Mills Twin Arena
- 24 Hewick Meadows
- 25 John C. Pallett Park
- 26 O'Connor Park
- 27 Sawmill Valley Trail

- 28 Streetsville Memorial Park
- 29 The Riverwood Conservancy
- 30 Tom Chater Memorial Park
- 31 Woodland Chase Trail

LIFESTYLE & OTHER

- 32 Anytime Fitness
- 33 Cineplex Cinemas
- 34 CoYoga
- 35 CrossFit Crosscheck
- 36 Erin Meadows Community Centre
- 37 Erin Mills Tennis Club
- 38 GoodLife Fitness
- 39 LifeLabs Medical Laboratory Services

SHOPPING

- 40 The Beer Store
- 41 Erin Mills Town Centre
- 42 Global Pet Foods
- 43 LCBO
- 44 Loblaws
- 45 Nations Fresh Foods
- 46 Shoppers Drug Mart
- 47 South Common Centre
- 48 Walmart Supercentre

SCHOOLS

- 49 Blessed Trinity Catholic Education Centre
- 50 Credit Valley Public School
- 51 Erin Centre Middle School

- 52 John Fraser Secondary School
- 53 Middlebury Public School
- 54 Oscar Peterson Public School
- 55 St. Rose of Lima Separate School
- 56 Thomas Street Middle School
- 57 University of Toronto - Mississauga

TRANSIT

- 58 Erin Mills GO Station
- 59 Streetsville GO Station



2 MINUTE WALK
TO CREDIT VALLEY HOSPITAL



7 MINUTE DRIVE
TO CINEPLEX CINEMAS

6 MINUTE DRIVE
TO SAWMILL VALLEY TRAIL

2 MINUTE WALK
TO ERIN MILLS TOWN CENTRE

5 MINUTE DRIVE
TO STREETSVILLE

403
4 MINUTE DRIVE
TO HWY 403

Map is not to scale. Travel times are approximate and may vary. Illustration is artist's concept. E. & O. E.



where friends are family and family are friends.

Living in a community where people from different cultures, ages and stages of life come together presents a unique opportunity to learn, share, and expand our hearts. Every individual brings their own unique perspective, skills, and experiences to the community, creating a diverse and vibrant atmosphere. It's a great way to make new friends and feel like you're a part of something bigger.

we are all kith.

THE Kith

CONDOMINIUMS

thekith@danielscorp.com | 905-306-6996

THEKITHCONDOS.COM



Daniels
love where you live™

Exclusive Listing: The Daniels Realty Corporation, Brokerage. Brokers Protected. Illustrations are artist's concept. Prices, specifications, and programs are subject to change without notice. E. & O. E.
All brand names, logos, images, text, and graphics are the copyright of the owners, Daniels HR Corporation. Reproduction in any form, without prior written permission of Daniels HR Corporation, is strictly prohibited.
See a Sales Representative for details.